

# Recognition Of Prior Learning

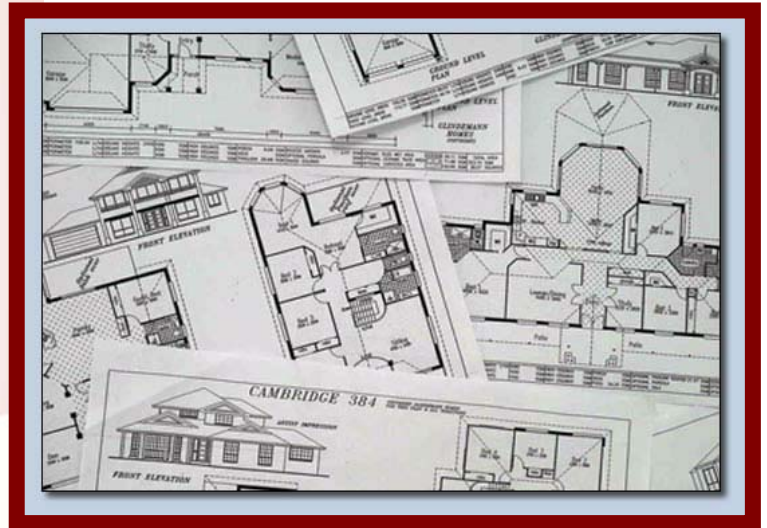

## Builder Low Rise – Certificate IV in Building and Construction (Building) Assessment Program

## BUILDER LOW RISE QUALIFICATION

This process of Recognition of Prior Learning to meet the technical requirements for a BSA licence for Builder Low Rise is a unique product. It has been developed specifically for existing members of the building and construction industry who have gained substantial skills and experiences however do not hold a formal qualification.

On successful completion of the assessment, you will be issued the technical qualifications required by the BSA for a Builder Low Rise Licence. Please be aware that the BSA has the final judgment for licence applications.

S/T Construction Techniques can also assist with completing your BSA Licence Application and provide guidance and help about BSA's requirements.

### WHAT TO DO

To apply for an assessment, you are required to provide information about yourself and your previous learning and experiences on the forms provided.

Copies of any formal qualifications should be supplied with this application. Original certificates or qualifications must be presented at the interview.

Upon registration of this application, you will be asked to take part in a self paced assessment program completed at home in your own time. Your completed assessment work will then be reviewed identify and confirm your skills and experience for this qualification.

Fill in this application form **AND THE ATTACHED BSA RESUME** and send back to S/T Construction Techniques with the assessment fee of \$2500.00 (GST FREE).

The total cost of the assessment is \$2500.00 which is inclusive of the Resource and Question and Session Projects Booklets. **(This is subject to the Completion Requirements)**

Resource and Question and Session Projects Booklets will be provided on payment of the assessment fee and relevant industry experience identified.

You will be required to purchase or have access to the following additional technical resources:

- The Building Code of Australia Volume 1 and 2 (current version);
- AS1684 Timber Framing standard for your region (current version)
- AS3740 Waterproofing Standards (current version)

Any travel and accommodation required outside Brisbane CBD may be charged in accordance with S/T Construction Techniques Travel Policy.

### THE CONSTRUCTION PROJECT

To complete this Project you will need to have access to a computer for certain applications. To satisfy all of the required competency standards the applicant must complete and submit the question and session projects booklet.

### Completion Requirements

**The assessment must be completed in 26 weeks from the date of enrolment. If you haven't completed in that time a re enrolment fee of \$1000.00 will be required for you to continue that program.** We will be scheduling a time for your final assessment interview at the 18 Week mark. This date may be bought forward as required. S/T Construction Techniques will not be forwarding the final outcome of assessment documents until all projects, assignments and questions have been received, reviewed and completed to our requirements. Only then will the assessment be complete.

If you have any questions about completing the registration form or BSA Resume, please do not hesitate to contact S/T Construction Techniques on 1300 665 517.

### REFUNDS

A 50% refund of the assessment fee will be made if you provide written confirmation to cancel the assessment 7 working days prior to the final assessment interview. For any further information on our refund policy please phone our office.

## S/T CONSTRUCTION TECHNIQUES - TOLL FREE 1300 665517

### BRISBANE OFFICE

PO BOX 5517  
STAFFORD HEIGHTS QLD 4053  
1187 GYMPIE ROAD  
ASPLEY QLD 4034

PHONE: (07) 3624 2500  
FAX: (07) 3263 2877  
[andrew@stct.com.au](mailto:andrew@stct.com.au)

### TOWNSVILLE OFFICE

PO BOX 1873  
THURINGOWA CENTRAL QLD 4817  
4 FAIRWAY CLOSE  
KIRWAN QLD 4817

PHONE: (07) 4723 7625  
FAX: (07) 4723 6974  
[boss@conteq.com.au](mailto:boss@conteq.com.au)

### CAIRNS OFFICE

P O BOX 6823  
CAIRNS QLD 4870  
9/381 Mulgrave Rd  
WESTCOURT QLD 4870

PHONE: (07) 4054 4178  
FAX: (07) 4054 6134  
[cairns@stct.com.au](mailto:cairns@stct.com.au)

**BUILDER LOW RISE RPL REGISTRATION FORM**

PLEASE TICK ✓ AND SUPPLY INFORMATION WHERE REQUIRED

Name:	Date of Birth:
Postal Address:	Postcode:
Home Telephone:	Mobile Telephone:
Work Telephone:	Email:
Country of birth	Are you of Aboriginal <input type="checkbox"/> Yes <input type="checkbox"/> No OR Torres Strait Islander Origin? <input type="checkbox"/> Yes <input type="checkbox"/> No
Do you speak a language other than English at home? <input type="checkbox"/> Yes <input type="checkbox"/> No	If Yes What Language:
Is your English easily understood by others? <input type="checkbox"/> Yes <input type="checkbox"/> No	
If help was available would you be interested in assistance to speak English? <input type="checkbox"/> Yes <input type="checkbox"/> No	

**WORK DETAILS**

<input type="checkbox"/> Self Employed (Contracting / Subcontracting)	<input type="checkbox"/> Employed (Wages)	<input type="checkbox"/> Other:
Are you seeking a BSA licence? <input type="checkbox"/> Yes <input type="checkbox"/> No		

**SCHOOLING**

Please List schooling and any other training (e.g. TAFE / University):
Was your schooling in: <input type="checkbox"/> Australia <input type="checkbox"/> Outside Australia If outside Australia - Name of Country:

**WORK HISTORY**

How many years have you worked in the Building & Construction industry?	Years
List any other skills that you believe could be credited to you:	
Please list any extra information that you feel will help validate your technical skills, such as other building industry or job experience you have gained in the past, this includes supervisory or technical work:	
Any comments on the registration form can be made below:	
Have you read the <b>completion requirements</b> in this booklet? <input type="checkbox"/> Yes <input type="checkbox"/> No	
Do you understand the <b>refund policy</b> explained in this booklet? <input type="checkbox"/> Yes <input type="checkbox"/> No	
Have you completed and attached the BSA resume? <input type="checkbox"/> Yes <input type="checkbox"/> No	
I hereby authorize S/T Construction Techniques to provide data collected to third parties for auditing and Government requirements.	
The information in this application is true and correct.	
Signed: _____	Date:     /     /
Please find enclosed payment of \$2500.00 application fee by: <input type="checkbox"/> cheque <input type="checkbox"/> money order <input type="checkbox"/> cash <input type="checkbox"/> DD	
Or please charge: <input type="checkbox"/> M/Card <input type="checkbox"/> Visa	
Card Holder's Name _____	Authorising Signature: _____ Date     /     /
Card No: _____/_____/_____	Expiry Date: _____/_____
<b>*Credit Card Payments incur a 2% surcharge</b>	
<b>Or Direct Debit to NAB 084 209 Account No. 482745784 - PLEASE STATE YOUR NAME AS A REFERENCE</b>	



## STUDENT DECLARATION (RPL)

I, \_\_\_\_\_,  
[Name]

Of, \_\_\_\_\_,  
[Address]

\_\_\_\_\_ Postcode \_\_\_\_\_,

Declare that the information and/or statements I provided regarding my industry experience are true and correct for the purposes of Recognition of Prior Learning for the Builder Low Rise Licence Assessment to be undertaken by S/T Construction Techniques.

Signed \_\_\_\_\_  
[Student]

Date:        /        /

---

## STUDENT ENTRY INFORMATION

### ENTRY REQUIREMENTS

Students must have functional literacy and numeracy skills. Certificate IV students need to be able to add, subtract and calculate ratios and percentages. Students need to be able to read and understand the course and reference material. S/T Construction Techniques assessment method is construction project based supported by related questions and assignments.

If you are unsure as to whether you meet the entry requirements S/T Construction Techniques can provide you with a Student Entry Questionnaire to assist in identifying your literacy and numeracy skills.

---

## BSA LICENSING REQUIREMENTS

BSA will require between 2 - 4 years relevant supervisory experience (which will depend on whether you have completed a carpentry or bricklaying apprenticeship) in addition to successful completion of the specific building industry qualification, approved by BSA as meeting the necessary technical requirements for a Builder Low Rise Licence.